

# Number of Lots per Acre vs Lot Size

Source: Tom J. Keith & Assoc, Inc

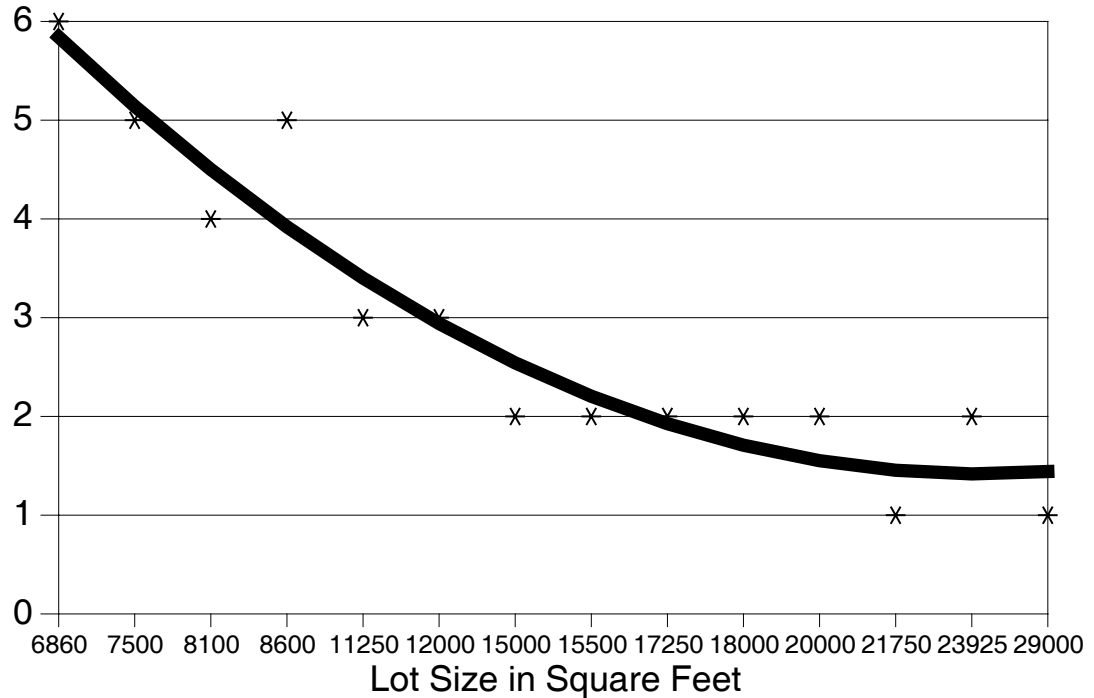

## Number of Lots per Acre vs Lot Size

This chart is employed by our firm to estimate the number of various size lots which can be developed from an acre of land. The chart is based on empirical data extracted from this market. Actual completed subdivisions were studied in order to determine how many lots were developed from an acre of land. This takes into consideration the area needed for streets and other areas that are not useable due to their shape. It assumes that most of the land is about 85% to 100% useable.